

Temperature Sensor Test Unit DC-700



*Browse
all products!*



Electronic Data

Supply Voltage	85 ... 264 VAC
Input	max. 160 VA
Measurement Range	500 Ω / 5 k Ω / 50 k Ω / 500 k Ω with automatic switch
Resolution	0,1 Ω / 0,001 k Ω / 0,01 k Ω / 0,1 k Ω
Tolerance	$\pm 0,5$ % of the measurement range ± 1 Digit
Resolution	0,25°C (0.45°F)
Tolerance	$\pm 0,5$ °C (0.9°F)
Temperature control range	-9°C ... +75°C (16°F ... +167°F)

Mechanic Data

Body Dimensions	310 x 300 x 135 mm (L x W x H)
Overall Height	230 mm
Weight	4,1 kg
Protection Class	IP 40
Display	LCD-Dot Matrix 2 lines with each 16 characters, 8 mm character height, Blue background, white font, LED-Light
Printer	Thermo-Printer, 42 Characters/Line, Paper width 57 mm
Electric Supply	IEC-Connector
Main Fuse	Micro fuse 5 x 20 mm, 4A Slow-Blow Fuse

Function Description

The temperature sensor(s) in your aviation Nickel-Cadmium battery have to be inspected and tested in intervals as mentioned by the respective original manufactures. These are defined in the applicable OMM / CMM / ICA provided by the original battery manufacturers.

In order to meet this requirement, Proponent Battery Services GmbH has designed a temperature sensor test unit and the necessary adapters/cables. With this practical new design, a wide range of temperature sensors can be easily, accurately and professionally tested. The Temperature Sensor Test Unit DC-700 is CE certified.



Temp. Sensor Test-Accessories

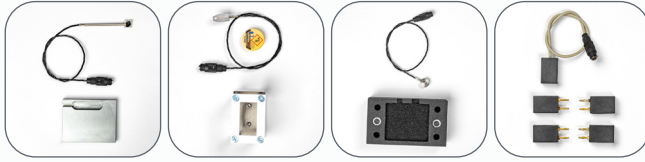

P/N:	Description:
DC-700-001	Temp. Sensor Test-Adapter
DC-700-002	Temp. Sensor Test-Adapter
DC-700-003	Temp. Sensor Test-Adapter
DC-700-A1 (Option)	Calibration Set



P/N:	Description:	Battery:
DC-700-T3S (Option)	Connection Cable	Saft 1606-1, Saft 1608-1, Marathon TSP-1735
DC-700-8-4S (Option)	Connection Cable	Saft 4076-13, Saft 4078-14, Marathon ATSP-44, Marathon ATSP-280
DC-700-10-6S (Option)	Connection Cable	Saft 4071-1, Saft 40678-2, Marathon TMA-5-20, Hawker F20/40H1CT
DC-700-12B12P (Option)	Connection Cable	Saft 4076-11, Saft 4579, Saft 539CH1
DC-700-P1 (1 set incl.)	Connection Cable	Saft 4000A1-1, Hawker F20/40H1C-E1 T2
DC-700-S1 (1 set incl.)	Connection Cable	Saft 40176-7, Marathon SP-747

Option: Accessories against extra charge

1 Set incl.: standard delivery scope: incl. 1 set of 2 connection cables

Temp. Sensor Test-Accessories



P/N:	Description:	Battery:
DC-700-S2 (Option)	Connection Cable	Saft 401176-9, Saft 442CH1, Marathon BTSP-400
DC-700-8-3S (Option)	Connection Cable	Saft 276CH10, Saft 2376-4, Saft 4076-10, Marathon STSP-400
DC-700-8-33S (Option)	Connection Cable	Saft 276CH7, Saft 4076-12, Marathon SP-376

Option: Accessories against extra charge

1 Set incl.: standard delivery scope: incl. 1 set of 2 connection cables

Recording a Measurement (Sample):

```

Temperature sensor
Assy Test
PN: .....
SN: .....
-----
Sensor
Active Pins: .....
TS1 470.0K 23.6°C/ 74°F
In Tolerance []yes []no
-----
Switch
Active Pins: .....
TS3 closes 65.4°C/150°F
In Tolerance []yes []no
-----
Test completed
Installed in
Battery Type: .....
Battery PN: .....
Battery SN: .....
Date: .....
Name: .....
Signature: .....
    
```

all rights for changes reserved

Made in Germany

 Proponent Battery Services GmbH

Hessenring 4b

D-64546 Mörfelden-Walldorf

GERMANY

Tel: +49 6105 9701 0

Fax: +49 6105 9701 44

Email: info@proponent-battery.com

www.proponent-battery.com